



# XRS

*Extreme Roll Up Series*



## Elite Model Installation Guide



**A**<sup>®</sup> Airlift Doors, Inc.  
Toll Free: 888-368-4403  
[www.airliftdoors.com](http://www.airliftdoors.com)

# **\*\*\*\*CAUTION\*\*\*\***

**Please read through these instructions before beginning installation of the door. Only trained professional door installers should attempt installation of the XRS series doors from Airlift Doors, Inc.**

**Some steps in this process require lifting up to 200 lbs and we strongly recommend using a mechanical lift or 3 people with proper lifting and safety equipment.**

**Always inspect your tools and equipment such as ladders and be sure all are in proper working operation before beginning the installation.**

**Depending on the model of door you have chosen, you will be installing a motor that operates on either 110v or 208v power. Only a licensed electrician should make the necessary connections to the motor and you should never attempt to service the motor without first disconnecting the power supply to the motor. Performing service on this motor without disconnecting the power supply may result in serious injury or death.**

**All components of this door have been engineered according to measurements provided to Airlift Doors, Inc. Do not attempt to modify any components or use any substitute parts without first consulting a factory representative of Airlift Doors, Inc. Failure to do so may alter the operation of the door and may create dangerous scenarios upon installation or normal operation that could result in personal injury or death. Any modifications to the product without factory approval will void all factory warranties.**

# XRS Parts List

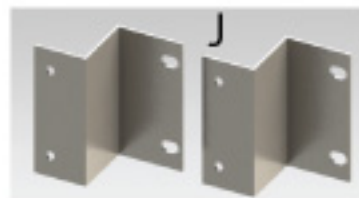
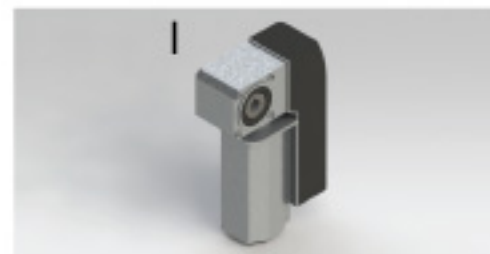
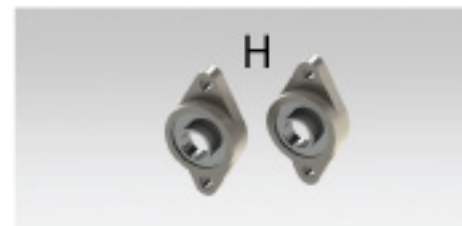
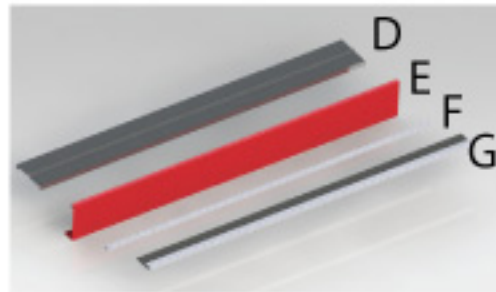

- A: Door Assembly
- B: Left Hand Track
- C: Right Hand Track
- D: Aluminum Cover w/Support Bar
- E: Vinyl Cover w/Support Bar
- F: Single Support Bar
- G: Double Support Bar w/Seal
- H: Bearings (2)
- I: XRS Opener
- J: Opener Mounting Brackets (2)
- K: Shaft Collar
- L: PVC Shaft Spacer (2)

Not Pictured  
M: XRS Fastener Kit

Optional Accessories  
N: Motor Cover

CAUTION

Please read all instructions prior to beginning installation. Use caution, improper installation of door can cause severe injury or death. Door to be installed by qualified personnel utilizing proper safety equipment.

### STEP 1 - MEASURE DOOR OPENING AND FLOOR TO CEILING HEIGHT

The door tracks have been pre-cut at the factory to match ceiling measurements given to us at the time of the order. **DO NOT CUT TRACKS WITHOUT CONSULTING THE FACTORY FIRST!! IF TRACKS WILL NOT FIT OR YOU FEEL THEY NEED TO BE CUT, PLEASE CALL TECH SUPPORT AT 1-888-368-4403 BEFORE PROCEEDING.**

### STEP 2 - UNPACK HARDWARE

Unpack door and all hardware. Confirm all parts listed in the parts list have been included.

### STEP 3 - DETERMINE LH & RH TRACKS

- 3-1: The left hand track will have the the bearing plate at the top and the brush seal pointed to the right towards the center of the door opening.
- 3-2: The right hand track will have the bearing plate at the top and the brush seal pointed to the left towards the center of the door opening.
- 3-3: For each track, the fastening portion of the track with the pre-drilled holes will be pointed away from the door opening.

### STEP 4 - MOUNT LEFT HAND TRACK

- 4-1: Place track against the wall so the stainless steel reset bracket is against the inside of the door jamb and the brush seal is pointed towards the center of the opening. (FIG. 4A & 4B)



FIG. 4A

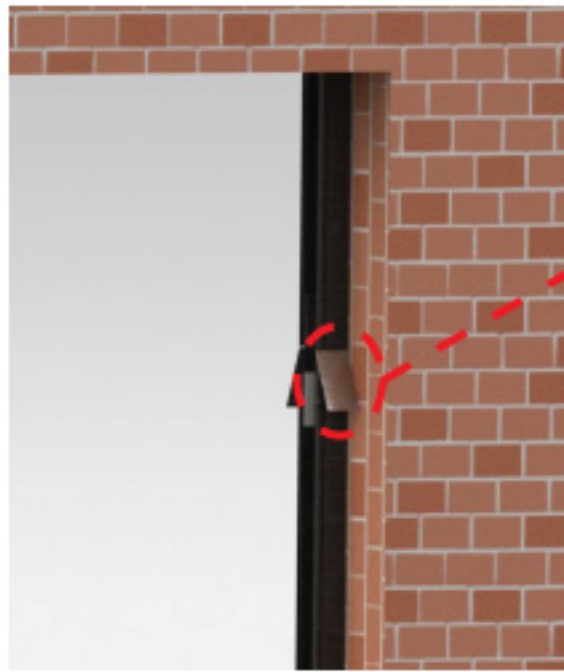

FIG. 4B

Stainless reset  
bracket flush against  
inside of door jamb.

#### STEP 4 - MOUNT LEFT HAND TRACK cont...

4-2: Level the track and mount to the door jamb at the midpoint of the track **using only 1 anchor at this time**. The remaining anchors will be used in a later step.

#### STEP 5 - MOUNT RIGHT HAND TRACK

5-1: Repeat step 4 for the right hand track assembly.

#### STEP 6 - MOUNT TOP COVER

6-1: Using two people, lift the aluminum top cover assembly onto the top of the bearing plates. Make sure the square support bar is on the bottom of the cover and is towards the wall. (FIG. 6A)

6-2: Using two 5/16" x 1" bolts, attach the cover support bar to each bearing plate. Use the inner most pre-drilled hole at the top of the bearing plates. (FIG. 6B)



FIG. 6A



FIG. 6B

#### STEP 7 - MOUNT VINYL COVER SUPPORT BAR

7-1: Unroll vinyl cover from aluminum support bar as shown in FIG. 7A below.



FIG. 7A

## STEP 7 - MOUNT VINYL COVER SUPPORT BAR cont...

- 7-2: Using two people, lift the support bar with the cover attached and fasten it to each bearing plate using two 5/16" x 1" bolts. The bar will mount to the outer most mounting hole at the top of each plate. Make sure the round head bolts that hold the vinyl cover to the support bar are on the inside, facing the door. This will leave 1/2 wrap of vinyl on the support bar. (FIG. 7B)

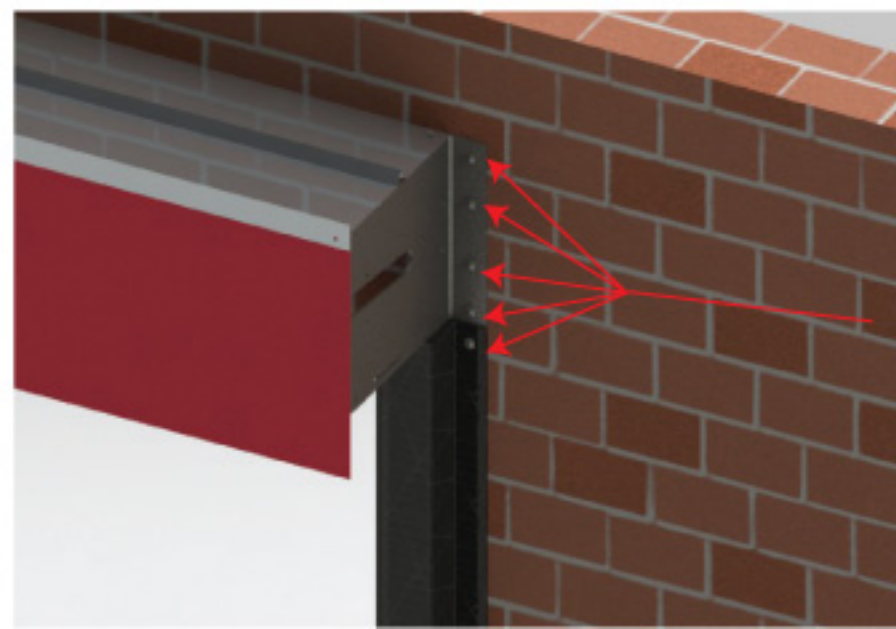

FIG. 7B

## STEP 8 - COMPLETE TRACK MOUNTING

- 8-1: Check that both tracks are level and square with the mounting surface.

- 8-2: Complete the mounting of the track by fastening the track to the wall through the remaining pre-drilled holes in both the track and the bearing plates. (FIG. 8A)



Fasten tracks and bearing plates to wall through all remaining pre-drilled holes.

## STEP 9 - INSTALL DOOR ASSEMBLY

**DO NOT REMOVE THE ROPES FROM THE DOOR ASSEMBLY YET. THE DOOR NEEDS TO REMAIN ROLLED UP UNTIL A LATER STEP!!**

CAUTION

**\*\*IMPORTANT\*\* USE EXTREME CAUTION WHEN LIFTING THE ROLLED DOOR ASSEMBLY INTO PLACE. DOOR WEIGHT IS APPROXIMATELY 160-200 LBS. LIFTING THE DOOR IMPROPERLY AND/OR USING LESS THAN THE RECOMMENDED NUMBER OF PEOPLE CAN RESULT IN SERIOUS INJURY OR DEATH.**

9-1: Lift vinyl cover on top of the door assembly so it is not in the way. (NOTE, the vinyl cover has been removed from the figures below for clarity.)

9-2: Slide one 3-1/8" PVC shaft spacer on each end of the shaft. (FIG. 9A)

9-2: Remove rolled door assembly from box. Using 3 people or a mechanical lift, lift the door assembly into place and slide the exposed ends of the shaft into the slots at the front of each bearing plate.

9-3: **\*\*IMPORTANT\*\*** Be sure to orient the door so the yellow bottom edge is closest to the wall. The door panels will unroll on the wall side of the tube.

SEE FIGURES 9A & 9B BELOW

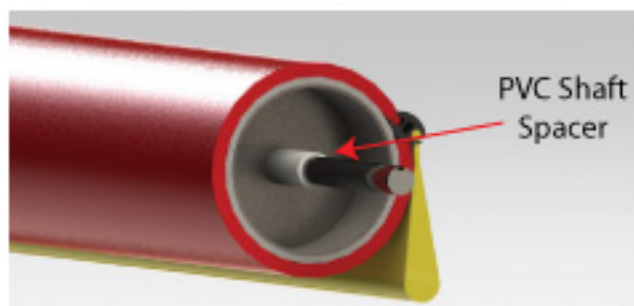

FIG. 9A



FIG. 9B

9-4: Lift the rolled door assembly into place by sliding the ends of the shaft into the slots at the front of each bearing plate. (FIG. 9C)



FIG. 9C

## STEP 10 - INSTALL BEARINGS

- 10-1: Slide bearing onto shaft. Lift the shaft slightly to align the the bearing mounting holes with the pre-installed 3/8" bolts. Slide the bearing onto the mounting bolts until it is against the retaining nut. (FIG. 10A)
- 10-2: Use (2) 3/8" lock washers and (2) 3/8" nuts to fasten the bearing to the bearing plate. (FIG. 10B)

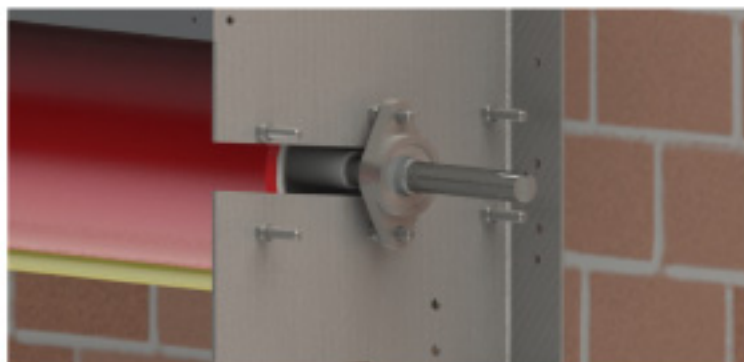

FIG. 10A

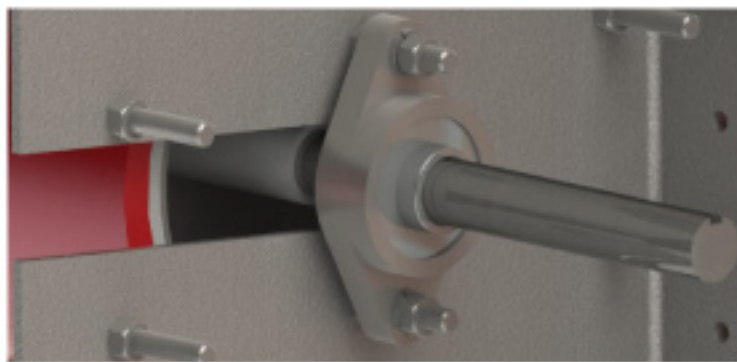

FIG. 10B

- 10-3: Repeat steps 10-1 and 10-2 for the opposite side of the door.

## STEP 11 - SET DOOR OPENING HEIGHT

- 11-1: Have one person place a vice grip on the door shaft on the side opposite to where the opener will be installed. This person must hold the vice grip firmly to prevent the door from unrolling.
- 11-2: While the vice grip is being held, have another person untie the ropes from the door assembly.
- 11-3: \*\*IMPORTANT\*\* Guide the edges of the door into each track and lower the door by hand until the bottom edge is at the desired opening height. For instance, if you have a 10' high opening, but only want the door to open to 8', you must lower it to 8' before proceeding. (FIG's. 11A & 11B)**
- 11-4: Once the door at the desired opening height, place the vice grip on the shaft and against the wall so the door remains in that position and doesn't unroll. Be sure to place the vice grip on the side of the door that the opener WILL NOT be mounted on. (FIG. 11C)



FIG. 11A (Door set to open to 10')



FIG. 11B (Door set to open to 8')



FIG. 11C

## STEP 12 - MOUNT BOTTOM SUPPORT BAR

12-1: Install the outer, bottom support bar to each bearing plate using (2) 5/16" x 1" bolts. (FIG. 12A)

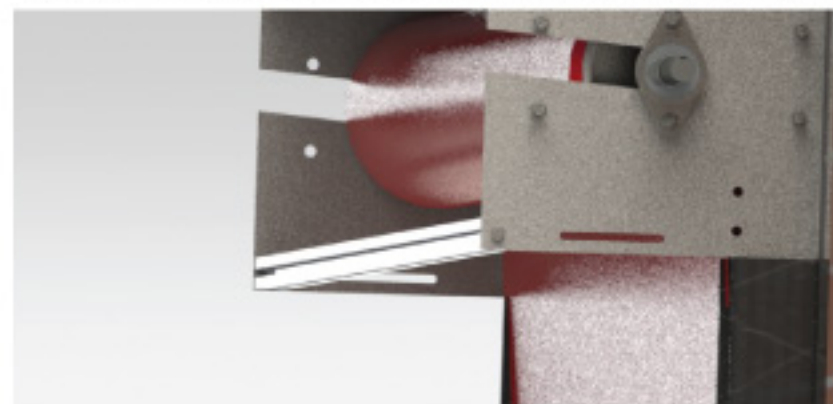

FIG. 12A

## STEP 13 - INSTALL T-NUTS

13-1: Lay the double wide support bar flat on the ground with the black rubber seal on top.

13-2: Slide (5) T-Nuts into the slot next to the rubber seal with the ball in the t-nut facing down and the flat portion facing up. (FIG's. 13A & 13B)

13-3: Space the t-nuts evenly along the length of the support bar.



FIG. 13A



FIG. 13B

## STEP 14 - MOUNT DOUBLE SUPPORT BAR

14-1: Flip the double support bar over so the rubber seal is on the bottom.

14-2: Mount the double support bar to the slot in the bottom of each bearing plate using (4) 5/16" x 1" bolts.

14-2: Do not tighten these bolts yet. Leave them loose so the bar can slide in the slot.

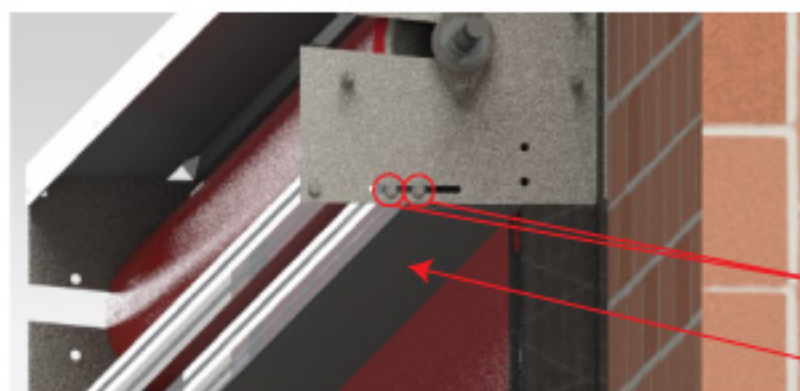

5/16" x 1" bolts  
(Do not tighten yet)

Black rubber seal  
on bottom

## STEP 15 - COMPLETE VINYL COVER INSTALL

- 15-1: Pull the front vinyl cover down and wrap it around the bottom support bars. (FIG. 15A)
- 15-2: Adjust the location of the t-nuts in the bottom slot of the double support bar so they are aligned with the 5 grommets in the bottom edge of the vinyl cover.
- 15-3: Using (5) 5/16" x 1/2" panhead bolts, fasten the vinyl cover to the double support bar. \*\*NOTE: Be sure to stretch the vinyl cover as you go to prevent a wrinkled appearance. (FIG. 15B)
- 15-4: Once the vinyl cover is fastened to the double support bar, slide the black rubber seal in towards the door until the vinyl cover is tight. (FIG. 15C)
- 15-5: While holding the rubber seal in place, tighten the (4) 5/16" x 1" bolts that fasten the double support bar to each bearing plate. (FIG. 15D)



FIG. 15A



FIG. 15B

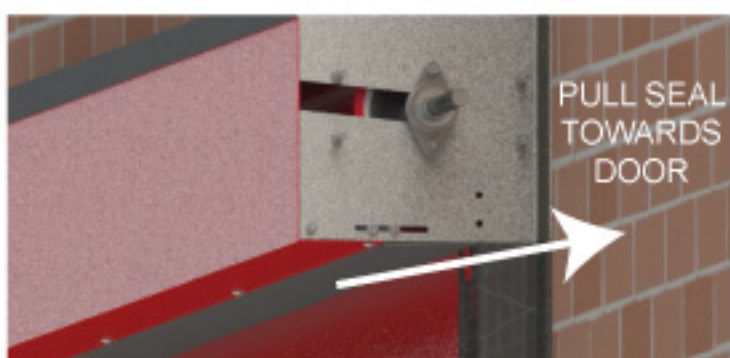

FIG. 15C



FIG. 15D

## STEP 16 - INSTALL POLY INTO BEARING PLATE SLOTS

- 16-1: Slide one of the 2" x 5" pieces of polycarbonate into the slot in each bearing plate as shown. (FIG's. 16A & 16B)

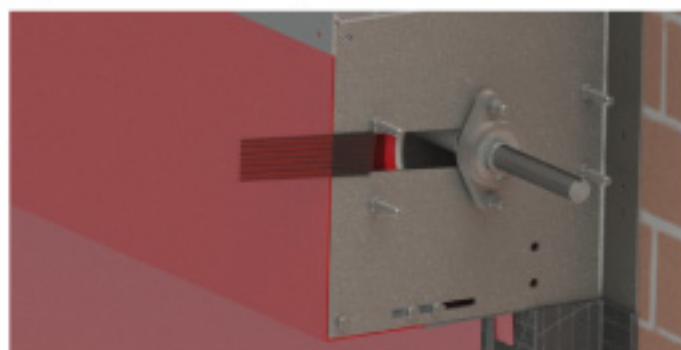

FIG. 16A



FIG. 16B

## STEP 17 - OPENER INSTALLATION

17-1: Unpack the opener and lay it flat on the ground.

17-2: Determine which side of the opener to attach the mounting brackets. **\*\*NOTE\*\*** When the opener is mounted, the black electronics cover will be facing away from the wall. (FIG's. 17A & 17B)



FIG. 17A (Right Hand Motor Mount)



FIG. 17B (Left Hand Motor Mount)

17-3: Attach the opener brackets to the correct side of the opener using (4) M8 x 1/2" bolts. **\*\*NOTE\*\*** The opener brackets mount to the opener through the smaller round holes, NOT the larger slotted holes.

17-4: Slide the opener onto the end of the shaft making sure the brackets are towards the bearing plate and the black opener cover is facing away from the wall. (FIG. 17C)

**\*\*OPTIONAL\*\*** Apply Anti-Seize to the door shaft before installing the motor. (Not supplied)



FIG. 17C

17-5: Align the slotted holes in the mounting brackets with the bolts on the bearing plate. Slide the opener onto the bolts. Fasten the mounting brackets to the bearing plate using 3/8" lock washers and 3/8" nuts. (FIG. 17D)

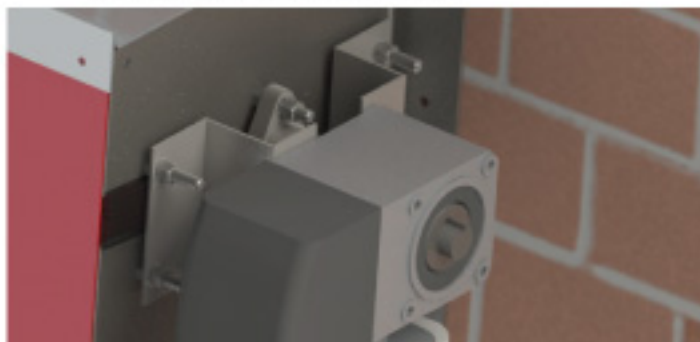

FIG. 17D

**STEP 17 - OPENER INSTALLATION continued.....**

17-6: Rotate the door shaft with a vice grip until the keyway of the shaft is in line with the key slot in the opener. You may also use the hand crank provided to rotate the opener shaft manually. (FIG. 17E)

17-7: Insert the opener key into the keyway and key slot and push it in until approximately 1/4" is sticking out and tighten the set screw. (FIG's. 17F & 17G)



FIG. 17E



FIG. 17F



FIG. 17G

17-8: Slide the 1" shaft collar onto the end of the shaft. Push it against the key and tighten the collar set screw. (FIG. 17H)

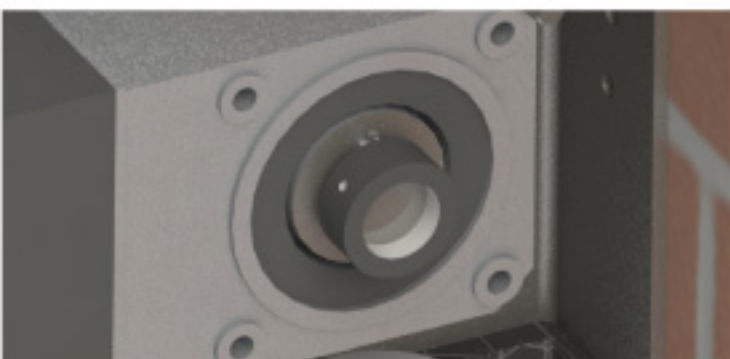

FIG. 17H

## **STEP 17 - OPENER INSTALLATION continued.....**

17-9: Mount and wire your door control according to the wiring insert included in your installation packet.

17-10: Proceed to step 18 when wiring is complete.

## **STEP 18 - INSTALL PHOTO EYES**

18-1: Using the aluminum mounting brackets provided, first mount each photo eye to a bracket.

18-2: Next, mount the brackets to the door track approximately 2 ft above the floor as shown below. (FIG. 18A or 18B)



FIG. 18A (Banner Eyes)



FIG. 18B (Telco Eyes)

18-3: Wire the photo eyes to the controls as specified in the wiring diagram included with this guide.

## **STEP 19 - OPENER ADJUSTMENTS**

The opener limits are set by adjusting two of the four plastic cams at the top of the opener.

- The green cam closest to the opener sets the open limit.
- The white cam, 2nd closest to the opener sets the close limit.

**\*\*CAUTION\*\*** Use extra care in adjusting the opener limits to prevent the door from opening too far and rolling over the top of the door assembly. Always be prepared to press the stop button to prevent the door from traveling too far.

**\*\*NOTE\*\*** The opener limits were preset at the factory to allow the door to travel within 1-2 ft of the floor. Only fine tune adjustments should be needed.

19-1: Press the close button and allow the door to move towards the close position. Take note of where the door stops above the floor.

## STEP 19 - OPENER ADJUSTMENTS *continued.....*

- 19-2: Open the door.
- 19-3: Using a 2.5mm allen wrench, turn the fine adjustment screw on the white close limit cam so that the cam turns clockwise. Do not adjust the cam more than one complete turn of the screw at a time as a small adjustment to the limit cam results in a large change in door travel.
- 19-4: Press close to test where the close limit is now set. If closing too far, or not enough, continue to adjust the close limit cam accordingly until the bottom of the door rests on the ground during the close cycle.
- 19-5: The open limit was pre-set at the factory to be within 6" of the desired opening height. However, a small adjustment may be necessary.

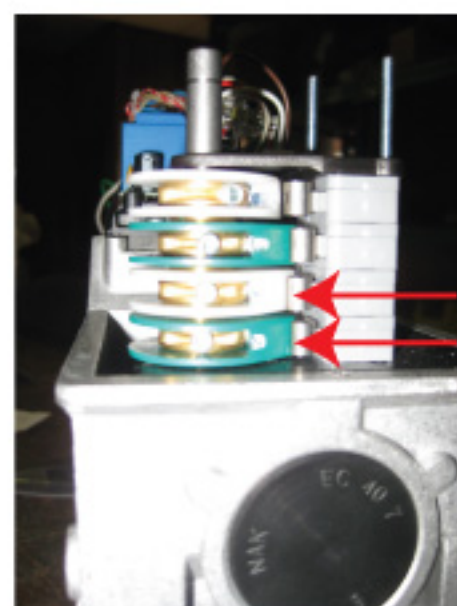

Close Limit  
Open Limit

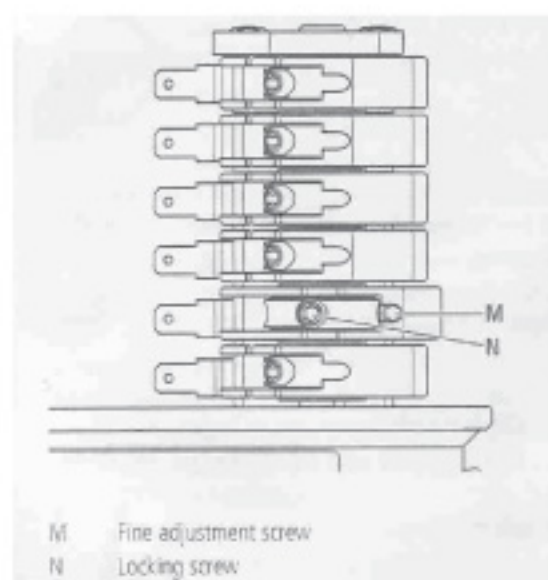

M Fine adjustment screw  
N Locking screw

**\*\*STOP\*\* Step 20 is only applicable if you have purchased an optional motor cover. If you did not purchase this item, skip this step.**

## STEP 20 - MOTOR COVER INSTALL (OPTIONAL)

- 20-1: Thread a 3/8" nut on the two outer mounting bolts located on the motor side bearing plate. (FIG. 20A)
- 20-2: Remove the front panel of the motor cover.
- 20-3: Lift the motor cover up and around the motor and align the slots in the mounting bracket with the mounting bolts that you threaded a nut onto. Push the motor cover onto the bolts until it is snug against the wall. (FIG. 20B)

## STEP 20 - MOTOR COVER INSTALL (OPTIONAL)

- 20-4: Level the motor cover and fasten the mounting bracket to the mounting bolts using a large 1-1/2" washer, a 3/8" lock washer, and a 3/8" nut.
- 20-5: Drill a 1/4" hole through the side of the door track using the hole in the 90 deg mounting bracket as a guide. Fasten the bottom 90 deg bracket to the track using a 1/4" bolt and nut. (FIG. 20D)
- 20-5: Re-install the front panel on the motor cover.



FIG. 20A

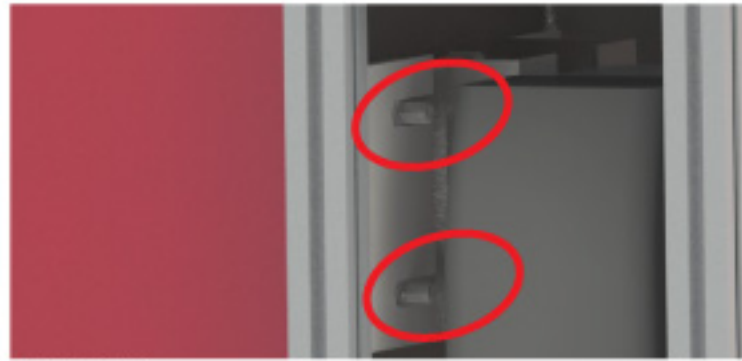

FIG. 20B



FIG. 20C

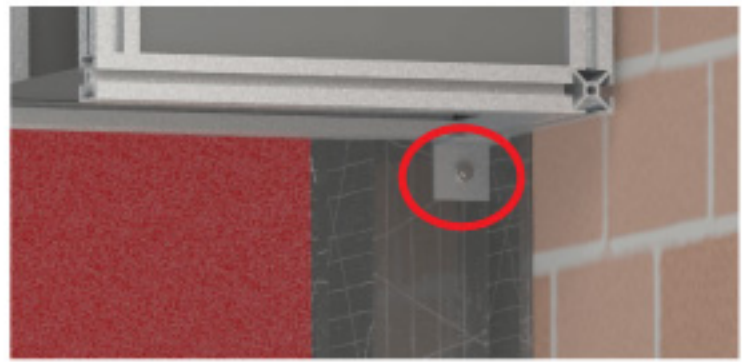

FIG. 20D

